



The main entrance to campus is located on US Route 15.

# Come for a Campus Visit!



Hatcher Hall, built in 1916, is where you'll find our Admissions Office and other administration and business offices.



Wicker Chapel is at the heart of the campus.



Cadets head for class around the Middle School Circle.

## Buildings / Facilities Key

### Administration Buildings

- 1 Hatcher Hall (Admissions Office)
- 2 Vaughan Hall (Commandant's Department)

### Classroom & Education Buildings

- 3 Hatcher Hall Classrooms
- 4 Perkins Technology Center
- 5 Retan Flag Hall / Band Room
- 6 J. C. Wicker Science Hall & Planetarium; Moretz Learning Center
- 7 Guy E. Beatty Library
- 8 Middle School Academic Building

### Barracks

- 9 Snead Hall
- 10 Memorial Hall
- 11 Middle School Barracks

### Athletic Facilities

- 12 Estes Athletic Center
- 13 Aquatic Center / Pool
- 14 M. C. Thomas Gymnasium
- 15 Middle School Gymnasium

### Food Services

- 16 Dorothy Thomasson Estes Dining Hall
- 17 Sabre Shop
- 18 Fork Union Motor Lodge

### Other Services

- 19 Yeatman Infirmary
- 20 Quartermaster

### Chapel & Memorials

- 21 John J. Wicker Chapel
- 22 Sarah Alice Bronson Commons
- 23 Veterans Memorial

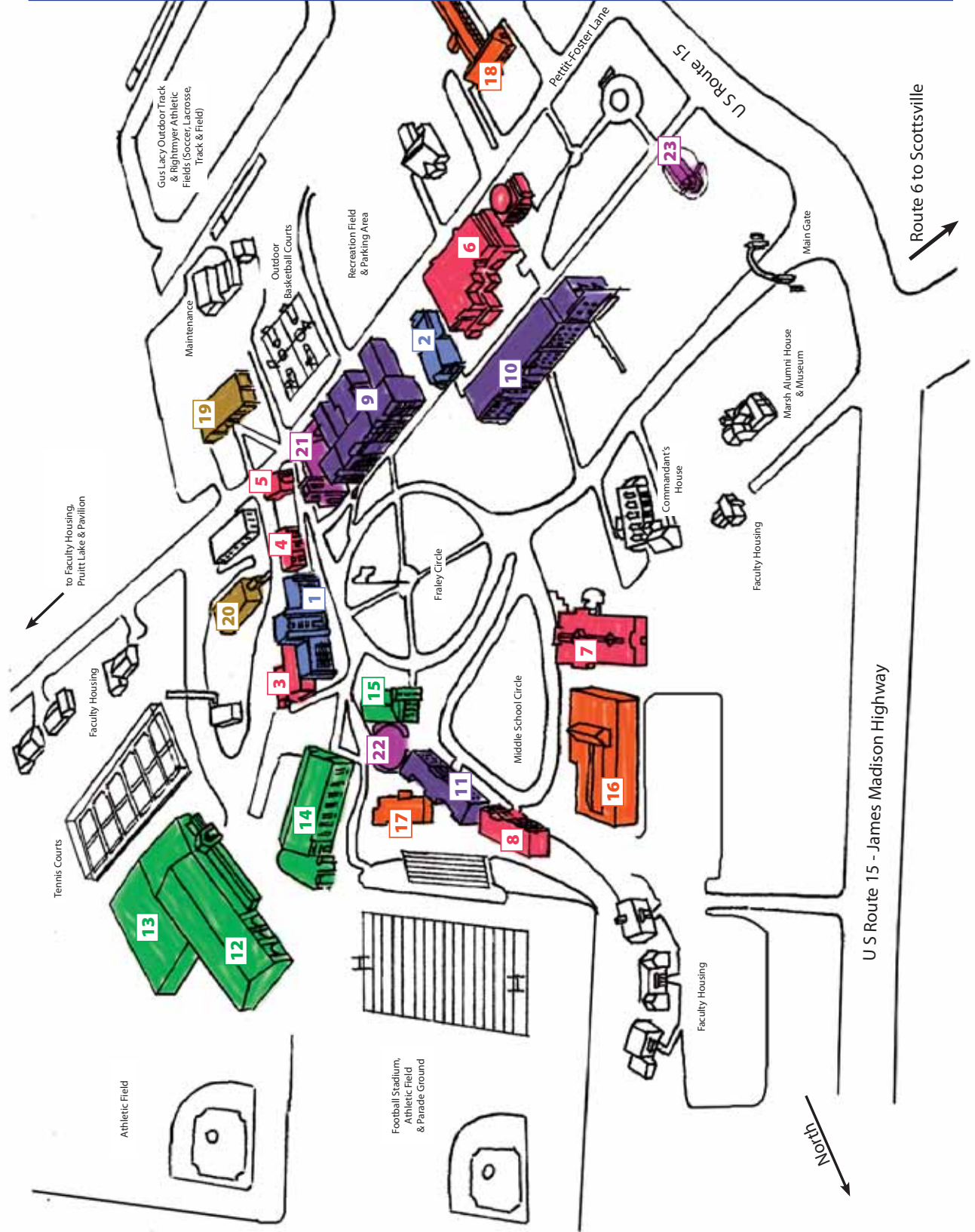

# Finding Fork Union Military Academy

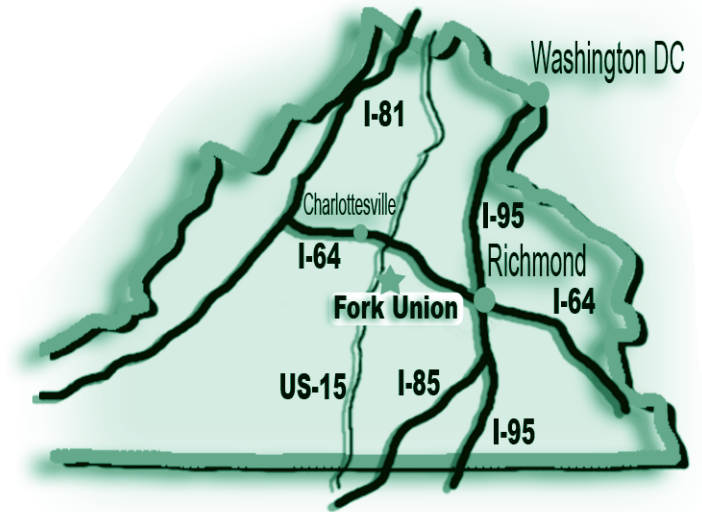

**F**ork Union Military Academy is located in the heart of central Virginia on Route 15 in the village of Fork Union.

## **From the Richmond area:** *(Easy Route)*

Travel west on I-64 about 50 miles to the Route 15 / Zion Crossroads Exit, Exit 136. Turn south on Route 15 and go approximately 17 miles to the village of Fork Union. Fork Union Military Academy is located on the east side of Route 15.

## **Alternate Route:** *(Shorter Route)*

Take I-64 West to Exit 167 (Goochland/Oilville exit). Turn left off of exit ramp and go approximately 1/2 mile to Route 250. Turn right onto Route 250 West; take Route 250 West about 3/4 mile to Route 632. Turn left onto Route 632. Take Route 632 for 5 miles, then turn left onto Route 522. Follow Route 522 until it ends at Route 6, then turn right onto Route 6; FUMA is 25 miles west on Route 6 in the center of the village of Fork Union.

## **From Washington, DC; New York/New Jersey; Philadelphia Areas**

Take I-95 South to Fredericksburg, VA. From Fredericksburg, take Route 3 West for approximately 15 miles to Route 20. Turn left onto Route 20 and travel 22 miles to Orange, VA. In Orange, take Route 15 South to FUMA (approximately 45 miles).

## **Alternate Route :**

Take I-495 South from the west side of Washington. From I-495, take I-66 West to Route 29 at Gainesville (approximately 22 miles). By-pass Gainesville on Route 29 and continue on Route 29 to Route 15 South (at Culpeper). Take Route 15 South to FUMA.

## **From Western NC & Atlanta Areas:**

Take Route 29 North through Greensboro and on to Danville, VA. From Danville, VA take US 58 East to South Boston. By-pass South Boston and take Route 360 East toward Keysville. As you by-pass Keysville, take the Route 15 North exit off of 360. Take Route 15 North to FUMA.

## **From Raleigh, Durham Areas:**

Go to Oxford, NC on I-85. At Oxford, take Route 15 North to FUMA, using by-passes at Keysville and Farmville, VA.

## **From Eastern North Carolina & Deep South Areas:**

Take I-95 North to Richmond. From Richmond, follow directions from Richmond Area via I-64.

## **From Western Virginia Areas:**

Take I-81 North to I-64 East to Exit 136 (Zion Crossroads). Turn right off of ramp onto Route 15 South. FUMA is 17 miles south of the interstate on Route 15.

## **From Roanoke Area:**

Take Route 460 East through Bedford, Lynchburg, and Appomattox to Farmville. At Farmville, take Route 15 North to FUMA (approximately 45 miles).

## **From the Midwest, Western Pennsylvania & Northwestern VA Areas:**

Take Ohio/Pennsylvania Turnpike (I-70) to I-81 South, to I-64 East, to Exit 136 (Zion Crossroads). Turn right off of ramp onto Route 15 South. FUMA is 17 miles south of the interstate on Route 15.